



MARK TUNSTALL
PROPERTY

OAKWOOD COURT

W14



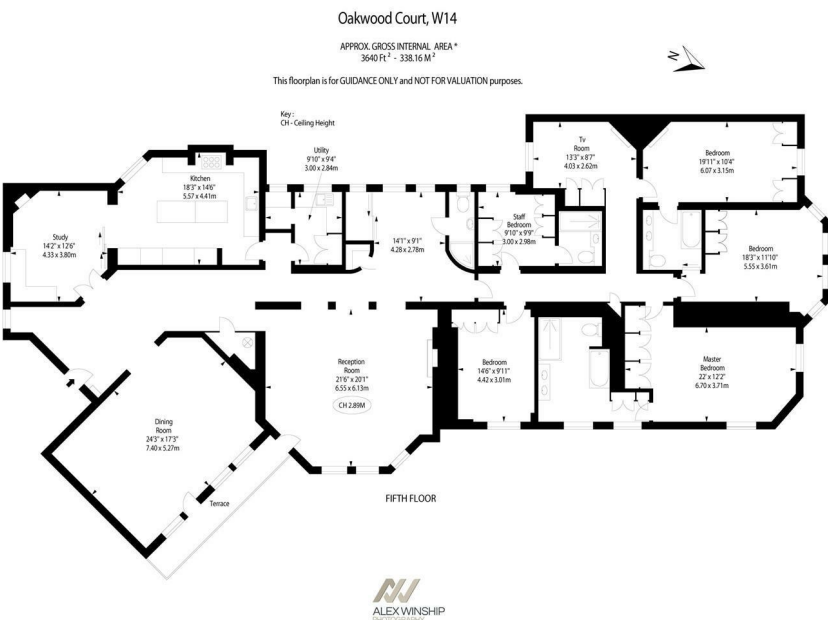

A spacious 5-bedroom (3,640 sq ft / 338 sq m) flat on the fifth floor of a highly-regarded mansion block adjacent to Holland Park offering exceptionally bright accommodation with wood or stone floors throughout. It benefits from two large reception rooms leading onto a terrace, a television room and study, plus five bedrooms and four bathrooms which will be newly decorated throughout.

Oakwood Court is located on the western border of Holland Park, between Kensington High Street and Holland Park Avenue, and therefore has an array of high-street and artisan shops and restaurants within easy walking distance, as well as excellent public transport links and some of the area's most highly regarded schools and nurseries.

Deposit: equivalent to six weeks' rent. Minimum tenancy length 12 months. Council Tax Band H.

Unfurnished

Viewing strictly by appointment with Mark Tunstall Property

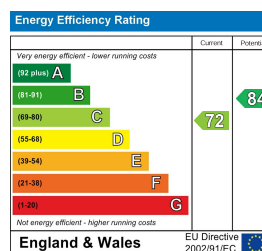

IMPORTANT NOTICE

THIS BROCHURE AND THE DESCRIPTIONS AND MEASUREMENTS HEREIN DO NOT CONSTITUTE REPRESENTATION AND WHILST EVERY EFFORT HAS BEEN MADE TO ENSURE ACCURACY, THIS CANNOT BE GUARANTEED. A COPY OF THE FULL ENERGY PERFORMANCE CERTIFICATE IS AVAILABLE UPON REQUEST.

INFO@TUNSTALLPROPERTY.CO.UK
+44 (0)20 3011 1775